

20/00235/PPP

23.04.2020



Indicative South East Elevation

Scottish Borders Council
Town And Country
Planning (Scotland) Act
1997

REFUSED

subject to the
requirements of the
associated Decision
Notice

AH

Aidan Hume Design
Architectural Services

113 Channel Street
Galashiels
TD1 1BN

email:- aidan.ahdesign@outlook.com
tel:- 07792 599343 or 07788 420822

Project:
**PROPOSED DWELLINGHOUSE AT
THICKSIDE FARM
JEDBURGH
TD8 6QX**

Client:
MR N MILLER

Title:
LOCATION PLAN

Scale: 1: 1250 Paper size: A3 Drawn by: AH Date: 26.02.20

Project no: Drawing no: Issue:

AH 096 LP01 A

© Aidan Hume Design Ltd. This drawing should not be copied or reproduced, or used for other than the noted project, without prior consent.

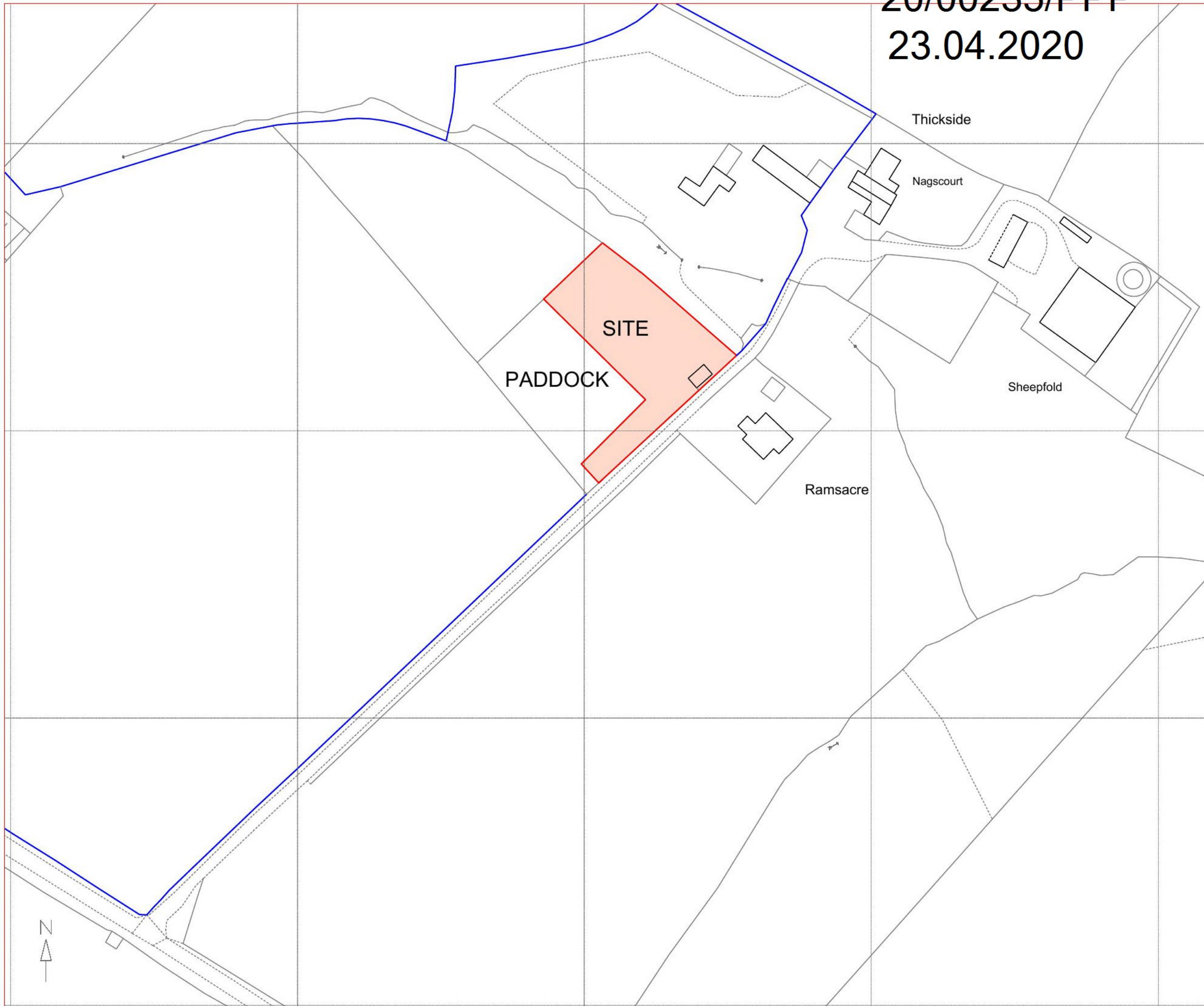

Nagscourt

indicative site for new house



INDICATIVE HOUSE TYPE

Site

access road and vehicular parking
and turning area

existing field shelter

Paddock

landscaping & planting to the
planners requirements

Scottish Borders Council
Town And Country
Planning (Scotland) Act
1997

REFUSED

subject to the
requirements of the
associated Decision
Notice

AH

Aidan Hume Design
Architectural Services

113 Channel Street
Galashields
TD11BN

email:- aidan.ahdesign@outlook.com
tel:- 07792 599343 or 07788 420822

Project:
**PROPOSED DWELLINGHOUSE AT
THICKSIDE FARM
JEDBURGH
TD8 6QX**

Client:
MR N MILLER

Title:
SITE LAYOUT

Scale: Paper size: Drawn by: Date:
1: 500 A3 AH 26.02.20

Project no: Drawing no: Issue:
AH 096 SP01 A

© Aidan Hume Design Ltd. This drawing should not be copied or reproduced, or
used for other than the noted project, without prior consent.

Ramsacre

ex field access

existing field access

